



PLEASE READ CAREFULLY AND FOLLOW ALL INSTRUCTIONS FOR YOUR OWN SAFETY.

! WARNING - To reduce the risk of fire, electric shock, product failure or serious personal injury:

When using the luminaire, the following important information and safety precaution should be followed at all times:

- An unswitched AC power supply of 120V to 277V is required.
- Always make sure the power is off before proceeding with assembling, disassembling, relocating, servicing or cleaning.
- Do not use this product for any purpose other than its intended use.
- Only use designated LED strips with the luminaire.
- Make sure all electrical connections conform to the National Electrical Code and all applicable local regulations.
- Do not let power supply cords touch hot surfaces.
- Do not mount near gas, electric heaters or heaters heaters air outlets.
- The emergency kit includes a battery pack, which is the rechargeable type and should be recycled or disposed properly. Battery acid can cause burns to skin and eyes. If acid is spilled on skin or eyes, flush acid with fresh water and contact a physician immediately.
- As this product contains batteries, please be sure to store it in an indoor environment of -20°C - 30°C. It must be fully charged and discharged every 6 months from the date of purchase until it is officially put into use, then recharged 30-50% and stored for another 6 months, and so on. If the battery is not used for more than 6 months, it may cause excessive self-discharge of the battery, and the resulting reduction of battery capacity is irreversible. For products with separate battery and emergency module, please disconnect the connection between battery and module for storage. Due to its chemical properties, it is a normal situation for the battery capacity to decline naturally during use. Users should take this into account when choosing products.
- Installation and servicing should only be performed by qualified service personnel.
- The luminaire should be mounted in locations and at heights where it will not be readily tampered by unauthorized personnel.
- The light source contained in this luminaire shall only be replaced by the manufacturer or his service agent or a similar qualified person.
- This luminaire is intended only for mounting in locations where the plug and socket are protected from unauthorized disconnection.
- If the external flexible cable or cord of this luminaire is damaged, it shall be exclusively replaced by the manufacturer or his service agent or a similar qualified person in order to avoid a hazard. The battery shall only be replaced by the manufacturer or his service agent specified model.
- Ensure product compatibility before final installation. Wiring should be strictly in accordance with the wiring diagram, wiring errors will damage the product. A case of safety accident or product failure caused by users' illegal operation does not belong to the scope of customer complaint acceptance, compensation or product quality assurance.

Specification

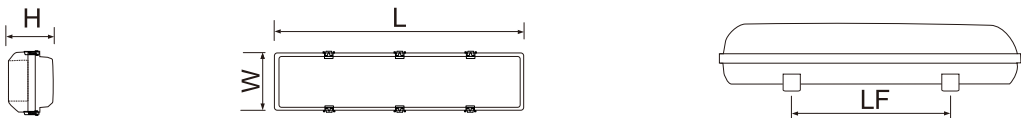
									
Unit: MM									
Model	Voltage	Power	Frequency	L	W	H	LF	Type	Emergency Time (Mins)
LL02H210	120-277V	23W	50/60Hz	670	161	102	400	Standard	0
LL02H218	120-277V	45W	50/60Hz	1273	161	102	984	Standard	0
LL02I210	120-277V	23W	50/60Hz	670	161	102	400	Emergency	90
LL02I218	120-277V	45W	50/60Hz	1273	161	102	984	Emergency	90
LL02J210	120-277V	25W	50/60Hz	670	161	102	400	Emergency + heating	90
LL02J218	120-277V	47W	50/60Hz	1273	161	102	984	Emergency + heating	90

1. Diffuser: Polycarbonate (PC).
2. Housing: Glassfiber Reinforced polyester (GRP).
3. Gear Tray: Painted iron plate, with all the electric components installed on.
4. Silicon gel gasket and PC (or stainless steel) clips ensure a high Ingress Protection for the complete luminaire.
5. The luminaire is designed for use outdoor or in wet locations.
6. The heating system can ensure the luminaire to work well under extremely cold weather. It starts working automatically when the luminaire's internal temperature is about 0°C, and stops working when the temperature reaches up to an appropriate ambient temperature.



Installation Instruction

CAUTION - Before installation, please always make sure the power supply is disconnected.

Electric Connection:

- Please use VDE or UL approved power cord, 1.0mm² or SJTW 18AWG for electric conduit connection.
- After connection, the end of conductors should not expose out of the terminal block.

Wiring Diagram:

Input Voltage: 120-277V

For LL02H210 / LL02H218

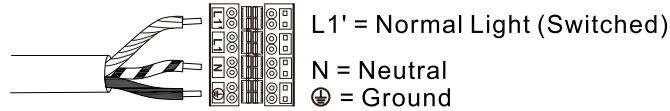

For LL02I210 / LL02I218

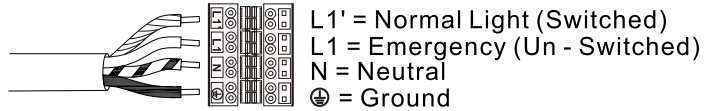

For LL02J210 / LL02J218

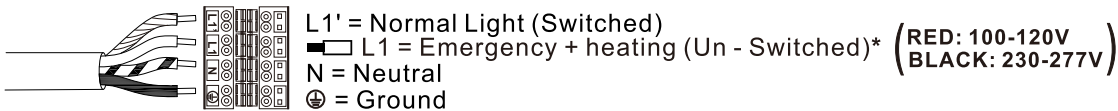

*L1: Appropriate wiring shall be selected according to the mains voltage at the final installation site of the project.

Mounting Size: (LF)

LL02H210/LL02I210/LL02J210

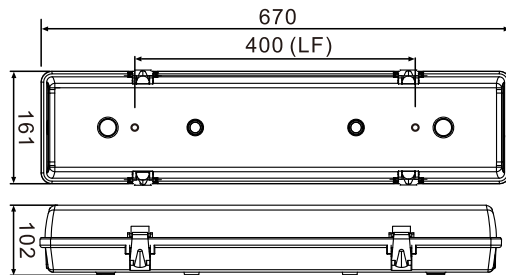

LL02H218/LL02I218/LL02J218

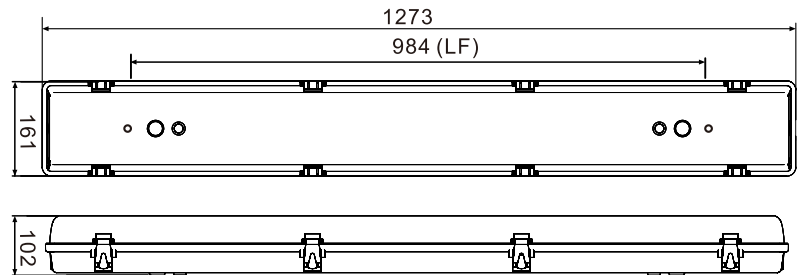

Mounting Manual:

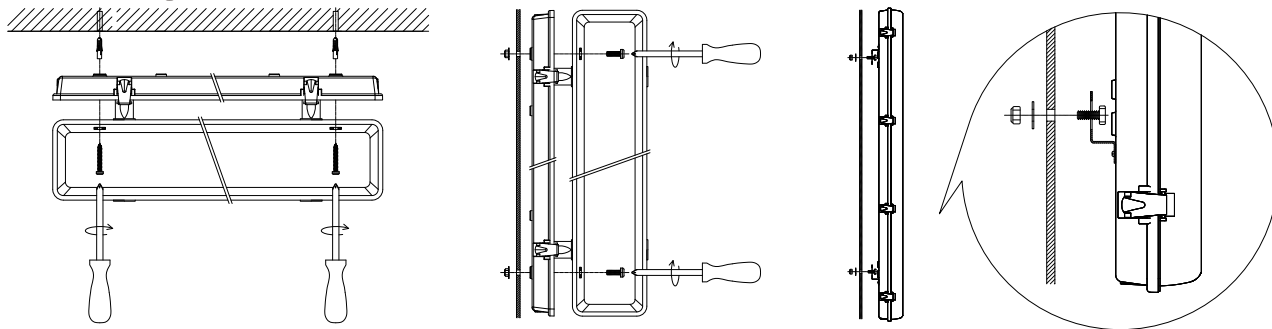

Notes: The end user can install an external switch to the circuit of L1' to turn off two lamps in normal operation, and the battery keeps being charged. Only when the mains power is failed, the luminaire goes into emergency operation at a reduced output.

Testing and Maintenance

For emergency (or emergency + heating) luminaires, the following testing and maintenance will be executed:
Press the LED Test Switch (LTS) to interrupt the power to AC driver and to force the luminaire into emergency mode, LED lamps are being lit at a reduced light; the LED Signal Lamp (LTS) turns off in emergency mode. After releasing the LTS, the luminaire returns to normal operation after a momentary delay, LED lamps are 100% lit, the LTS turns on. Allow the luminaire to be charged approximately 1 hour, and then press the LTS to conduct a short discharge test. Allow a 24-hour charge before conducting a 90 minutes discharge test.

Initial Auto Test - When the system is connected well and powered on, the module will Auto Test if the load and battery pack are connected well and if the battery is being charged normally.

Preprogrammed Scheduled Auto Test

- Carry out first monthly Auto Test after Initial power on for 24 hours to 7 days, afterwards, carry out a monthly Auto Test every 30 days.
- Carry out an annual Auto Test every 52 weeks after first powered on.

LED test switch (LTS) INDICATION

- LTS slow flash: In charging
- LTS on: Battery full charged in normal operation
- LTS off: Power failure
- LTS gradual change: In testing
- LTS quick flickering: Abnormal